

VAPOR RECOVERY UNITS

INCREASE REVENUE & BECOME EPA COMPLIANT!

We've developed best-in-class solutions to help capture fugitive gas and reduce greenhouse gasses.

VRU Features

- Turnkey Solutions for Rotary Screw, Sliding Vane and Reciprocating compressor types
- Electric Motors (TEFC) or Natural Gas Driven Engine
- Code Stamped Pressure Vessels (ASME UM)
- Gas After Coolers and Lubricant Coolers (ASME U)
- PLC Control Panels UL Listed- NEMA 4X Modbus Protocol RS232
- Low and High pressure gas recycle loops for extra capacity control
- Variable Frequency Drive Panels UL Listed 3R Standard or 4X Purged Option Available
- Large Daylight Readable Color Touchscreen
- Packages Classified as Class 1, Division 2. Div 1 Available
- Compliant with EPA 40 Code of Federal Regulations, Part 60 Subpart 0000a
- ANSI B31.3 Piping, ANSI B31.8 Tubing, AWS D1.1. Structural Steel Assembly
- Substantial field services geographic footprint

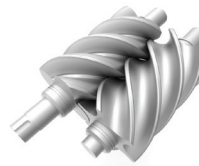

Learn
MORE

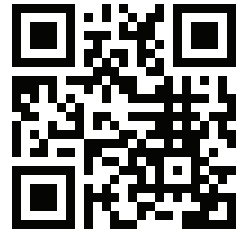

11/16/2020		Compressor-Pack VRU		10:33:22	
VRU is Shutdown					
Suction Scrubber - PSI	1.22				
Comp Lube Inlet - PSI	37				
Gas Discharge - PSI	0	Comp Speed - Hz		0	
Final Discharge - PSI	0	Inlet Valve Open		<input type="button" value="CLS"/>	
Oil Reservoir - PSI	37	Cond Pump Run		<input type="button" value="OFF"/>	
Comp Discharge - DegF	79	Comp VFD Run		<input type="button" value="OFF"/>	
Comp Lube Inlet - DegF	88	Tdy-Min		Ydy-Min	
Final Discharge - DegF	46	104		0	
		Total-Hr		1.7	
PRES	TEMPS	CONTROL SETPOINTS	RUN TIMERS	AUTO RESTARTS	ALARM LOG
START	STOP	FIRST OUT ALARMS		UPDATE	

About US

SCS Technologies is the leading Texas-based original equipment manufacturer for skid mounted measurement systems and environmental gas solutions. SCS is a vertically integrated service company which provides consumables, maintenance parts, commissioning, start-up and preventive maintenance for a variety of equipment. SCS couples competitive pricing with feature-rich systems and holds true to rigid design standards that allow us to provide our customers with an outstanding investment in capital equipment. Please explore our website scslact.com, for an overview of our product and services offerings.